



IMPORTANT SAFETY INSTRUCTIONS

Please read this manual carefully and follow its instructions. Improper use or failure to follow these instructions could result in serious injury, death or property damage. Operators should be instructed in the safe and proper use and maintenance of this product. Keep this manual for future reference.

The following safety precautions call attention to potentially dangerous conditions.

 **DANGER:** Immediate hazards which **WILL** result in severe personal injury or death.

 **WARNING:** Hazards or unsafe practices which **COULD** result in severe personal injury or death.

 **CAUTION:** Hazards or unsafe practices which **MAY** result in *minor* personal injury or product or property damage.

NOTE: Instruct operators in the safe, proper use and maintenance. Keep this manual for future reference.

INSTALLATION

 **WARNING:** Since this is for static grounding, care must be taken to be sure the unpainted surfaces of the mounting feet are properly grounded for static drain to work. Improper use or failure to follow these instructions lead to hazards or unsafe practices that **COULD** result in severe personal injury or death.

 **CAUTION:** Operator should be instructed in the safe, proper use and maintenance of this product. Hazards or unsafe practices **MAY** result in *minor* personal injury or product or property damage.

MOUNTING

Mount reel in desired location. Shaft of reel must be horizontal.

OPERATION

SPRING TENSIONING

Pull out grounding cable (III) to determine if tension is sufficient for intended use.

To Increase Tension

Apply wrench to flats on mainspring shaft, rotate clock wise (+) until proper tension is reached (II). After adjusting tension, pull cable to fullest extension to ensure full travel is possible. If cable does not reach full extension, some tension turns must be released.

To Decrease Tension

Depress mainshaft tension lock spring on opposite side of reel (I). If too much tension is removed, increase tension as described above.

If proper tension and extension cannot be achieved, consult the factory.

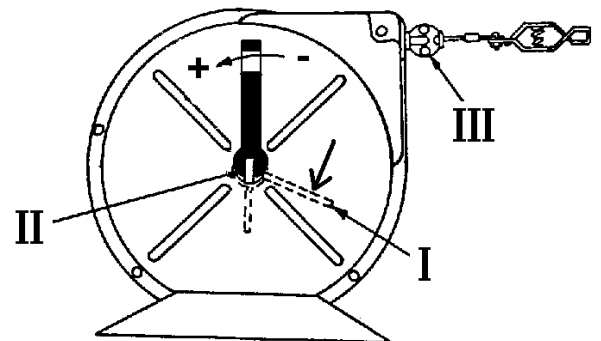

I = Mainshaft Tension Lock, Press to Release.
II = Shaft Flats; Main Spring Tensioning
III = Assembly; Cable Stop

RATCHET LOCK

2050 Models – Lock ratchets in two positions, about every 9” of cable travel. Pull cable to desired location and let cable retract slightly until lock engages. To release lock, pull cable out about 6” and release. If ratchet lock is not wanted, 2050CT version should be ordered since ratchet lock is not disengageable. 2050-CT Models are available for constant tension, no ratchet lock.

CABLE STOP ADJUSTMENT

Cable stop can be moved up along the cable, but moving the cable stop will reduce active travel.

SERVICING

CAUTION: Remove all tension before removing mainspring. Hazards or unsafe practices which MAY result in *minor* personal injury or product or property damage.

WARNING: Spring is dangerous. Always wear gloves. Before removing broken spring, weld coils together at four (4) locations or wrap securely with wire. Hazards or unsafe practices COULD result in *severe* personal injury or death.

SPRING REPLACEMENT

Remove tension by applying a wrench to flats of mainshaft. Release the mainshaft tension lock spring on opposite side (See Spring Tensioning Section) and rotate wrench slowly in tension releasing direction (-). Remove the six screws & housing. Remove drum-cover nuts and cover. Carefully remove mainspring from drum.

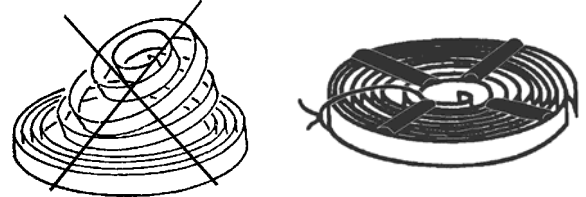

If hub comes off shaft with spring, replace hub into new spring while making sure hub engages spring coils. Replace spring in drum while making sure the spring engages in the lip on drum. To reassemble, reverse the above procedure. Be sure the hub engages the pin on the main shaft when reassembling.

CABLE REPLACEMENT

Remove tension by applying a wrench to flats of mainshaft. Release mainshaft tension lock spring on opposite side (See Spring Tensioning Section) and rotate wrench slowly in tension releasing direction (-). Remove housing exposing cable assembly. Cable assembly may be replaced by removing one nut. When replacing cable, be sure to first thread through guide. To reassemble, reverse above procedure.

SHAFT TENSION MECHANISM

To service lock, remove ring, washer and tension lock spring. To remove tension lock spring from shaft, depress spring slightly and rotate gently.

INSPECTION

Be sure unit is mounted securely when servicing reel. Inspect cable periodically for fraying. Lubrication is neither required nor recommended as product is prelubricated for life at factory.

REPLACEMENT PARTS

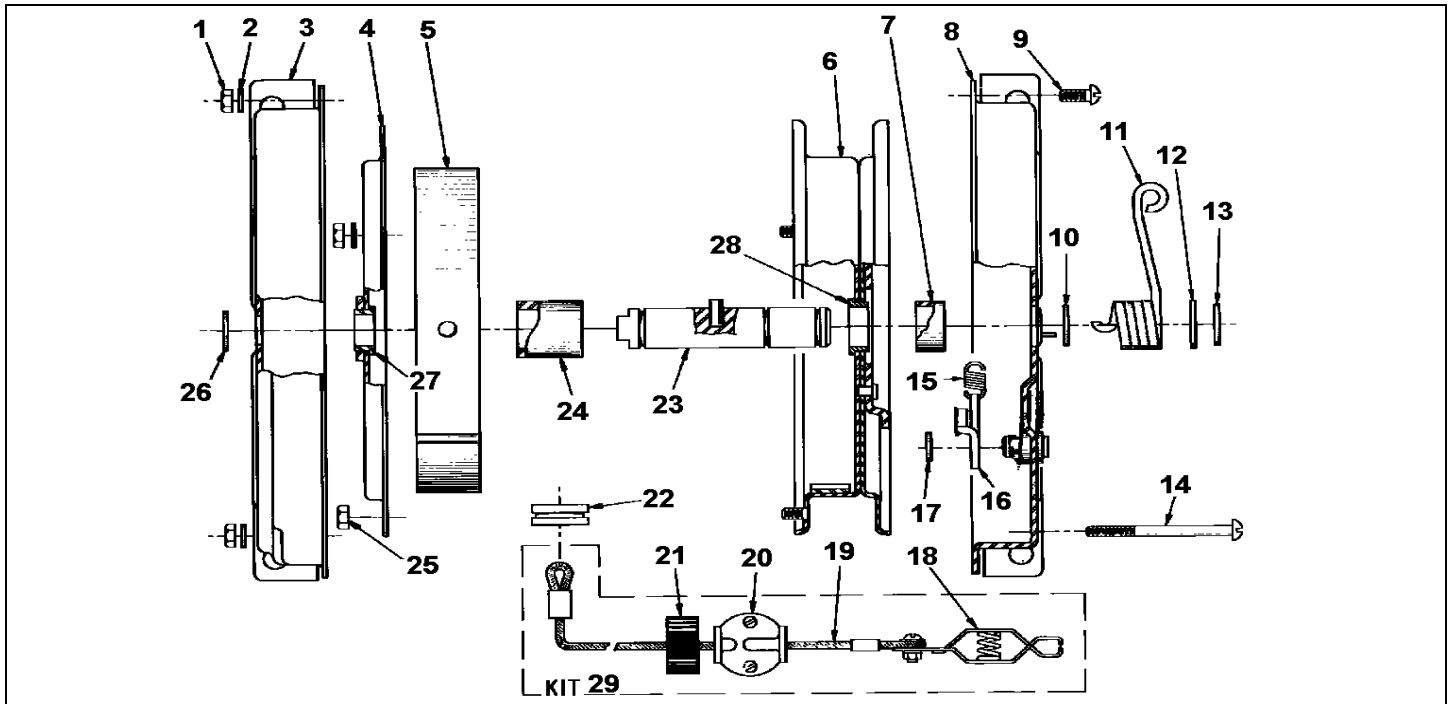

Ref. No.	Part Number	Qty.	Description
1	00151P0085	7	Nut
2	00103P0035	7	Washer
3	0968500004	1	Cover; Outside
4	0967100000	1	Cover; Drum
5	0961800545	1	Spring; Main
6	0967200000	1	Assembly; Drum
7	0961100000	1	Spacer
8	H22520009	1	Cover; Lock Side
9	0967100000	4	Screw
10	00580P0045	1	Ring; Retaining
11	0961600000	1	Pin; Tension Lock
12	0981300000	1	Spacer
13	00580P0045	1	Ring; Retaining
14	00002P0114	1	Screw
15	C60610118	1	Spring
16	0962200000	1	Arm; Lever
17	00580P0030	1	Ring; Retaining
18	0983500000	1	Assembly; Grounding Clamp 2050 (Includes mounting screws)
	0983500000	2	Assembly; Gounding Clamps 2050Y
19, 20 & 21	0966100050		Cable, & Stop 2050, 2050CT,
	4107100003	1	Cable, & Stop 2050Y
	0971900050		Cable, & Stop 2050NC, 2050NCCT
22	1361300000	1	Guide; Cable Guide Outlet
23	0967300000	1	Assembly; Shaft with Pin
24	1405800002	1	Hub
25	00160P0078	1	Nut; Lock
26	C01700131	1	Ring; Retaining
27	1361000001	1	Bearing; Cover Side
28	1361000002	1	Bearing; Drum Side
29	0968600050	AR	Kit; Cable 2050 (Includes Items #18 through #21)
	3006800000		Kit; Cable 2050Y

Aero-Motive Company

W A Woodhead Industries Inc. Subsidiary
 PO Box 2678
 Kalamazoo, MI 49003-2678
 USA
 (269) 337 7700 / (800) 999 8559
 FAX: (800) 333 6119
 www.aeromotive.com
 techhelp@aeromotive.com

Woodhead Connectivity LTD.

W A Woodhead Industries Inc. Subsidiary
 Factory No. 9
 Rassau Industrial Estate
 Ebbw Vale Gwent NP23 5SD
 United Kingdom
 44-1495-356300
 FAX: 44-1495-356301
 sales@wdhd.co.uk

Woodhead Asia PTE LTD.

W A Woodhead Industries Inc. Subsidiary
 No. 4 Toh Tuck Link
 Level 3 Mezzanine
 Markono Logistics Bldg.
 Singapore 596226
 65-6-261-6533
 FAX: 65-6-261-3588
sales@wasia.com.sg

Woodhead Canada LTD.

W A Woodhead Industries Inc. Subsidiary
 1090 Brevik Place
 Mississauga Ontario
 L4W 3Y5 Canada
 (905) 624-1079
 FAX: (905) 624-9151
www.woodhead.ca